

## Battery Loading

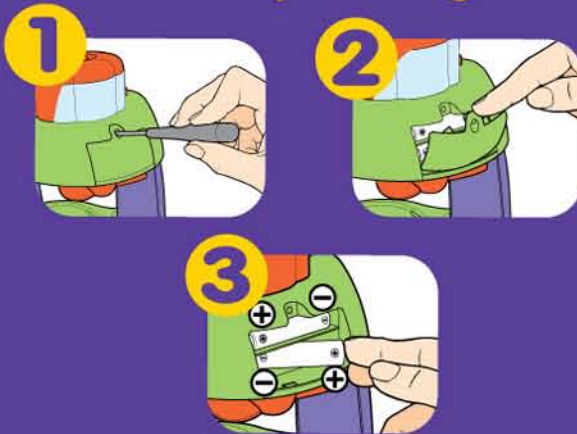

1. Ensure the fan is turned off. Using a Phillips head screwdriver remove the screw. (Fig.1)
2. Remove the battery compartment door. (Fig.2)
3. Insert 2AA batteries into the Battery chamber. Check that the (+) and (-) on the battery are aligned according to the polarity information shown on the contact plate. (Fig.3)
4. Replace the Battery Compartment Door and replace screw.

## Design Difficulty



## Trays

Make sure template symbol matches tray colour.

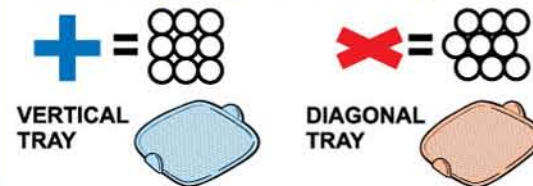

## Removing Beads

Use your bead removal tool as shown to pick up incorrectly placed beads. Tip: To clean bead removal tool wash in warm soapy water and allow to dry.



## Beados Design Tips

- Too much water on design will make the beads sticky and requires a much longer drying time.
- The surface of the design should be dry to touch before removing from tray.
- Gently sliding a card underneath the design will help remove it easily.
- Leave design to dry overnight for a stronger join.
- To make the design stronger spray water on reverse side of final design.
- Place your dried Beados designs underneath a book to flatten designs.
- Make sure you hands are dry when touching the beads. If wet beads stick to fingers please wash hands with soap and water.
- Wash tray well after use with warm soapy water and dry before next use.

## Tips: Trouble Shooting

- If beads get stuck in pen turn pen upside down and shake.
- If beads get stuck in the bead storage lift lid and push finger down into beads and replace lid.
- Turn fan off after use.
- Use bead remover to remove beads and eject the remaining beads with pen.
- If Super studio fan does not work check that the batteries have been correctly inserted.
- If fan slows down, replace batteries(2 x AA /LR6).

## Battery

- Alkaline batteries recommended.
- Do not use rechargeable batteries.
- Non-rechargeable batteries are not to be recharged.
- Different types of batteries, or new and used batteries are not to be mixed.
- Only batteries of the same or equivalent type as recommended are to be used.
- Batteries should be replaced by an adult.
- Batteries are to be inserted with the correct polarity.
- Exhausted batteries are to be removed from the product.
- The supply terminals are not to be short-circuited.
- Batteries are to be removed from the product when not in use.
- Do not dispose of batteries in fire.
- (2 x AA /LR6) not included.
- Keep instruction for future reference.
- Protect the environment by not disposing of this product with household waste. Check your local authority for recycling advise and facility.



NON TOXIC

FOR AGE  
4+

# BEADOS

Magically join with water!



## SUPER STUDIO INSTRUCTIONS

DO NOT PLACE BEADOS IN MOUTH.  
CONTENTS AND COLOURS MAY VARY.  
IMPORTANT: PLEASE RETAIN THE PACKAGING AND INSTRUCTION SHEET.  
THEY CONTAIN VALUABLE PRODUCT INFORMATION. DO NOT DISCARD.  
ADULT SUPERVISION OF YOUNG CHILDREN IS RECOMMENDED.  
AS THE BEADS CONTAIN A BITTER TASTE, IT IS ADVISED TO WASH HANDS  
AFTER USE.



Created and Manufactured by  
MOOSE ENTERPRISE PTY LTD  
MELBOURNE, AUSTRALIA.  
www.mooseworld.com.au  
info@mooseworld.com.au  
© MOOSE 2008  
MADE IN CHINA



New Bead  
Formula

## How To Begin

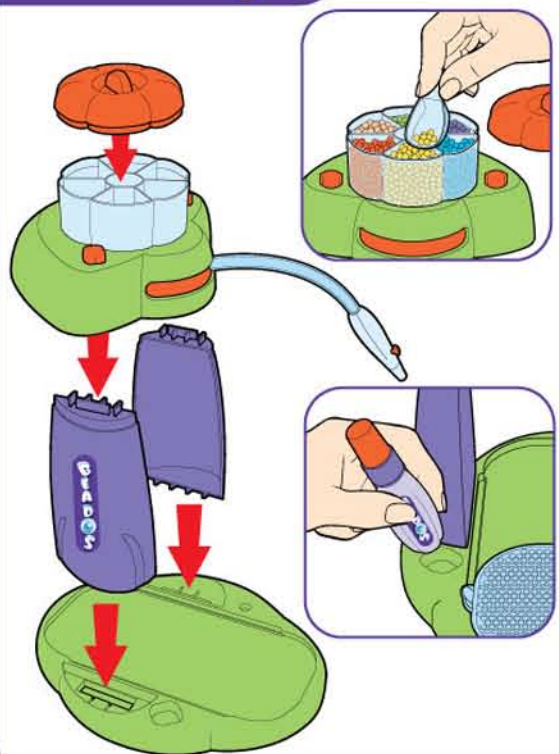

**1** Remember:  $+$  =   $-$  = 

**2** Place tray with template into super studio as shown.



**3** Turn bead storage so chosen bead colour is facing front.



**3** Turn bead storage so chosen bead colour is facing front.



**4** Push button to release beads into pen.



**5** Push pen button to place beads onto the tray.



**6** Holding 10cm away from design, evenly spray your complete design approx 2-4 times. \*(See tips)



**7** Push tray under fan.



**8** Push fan button. Allow 5-10 minutes to dry before removing.

